

COMUNE DI S. GIORGIO IN BOSCO

PROVINCIA DI PADOVA

VARIANTE P.R.G. n°14

INDIVIDUAZIONE DEGLI ANNESSI RUSTICI NON PIU'
FUNZIONALI ALLE ESIGENZE DEL FONDO AGRICOLO
(ART. 4 L.R. n°24/85)

OSSERVAZIONI

SCHEDA N°.	INDIRIZZO	foglio catastale	mappale
OSS.32	VIA PIAVE, 3	30	90

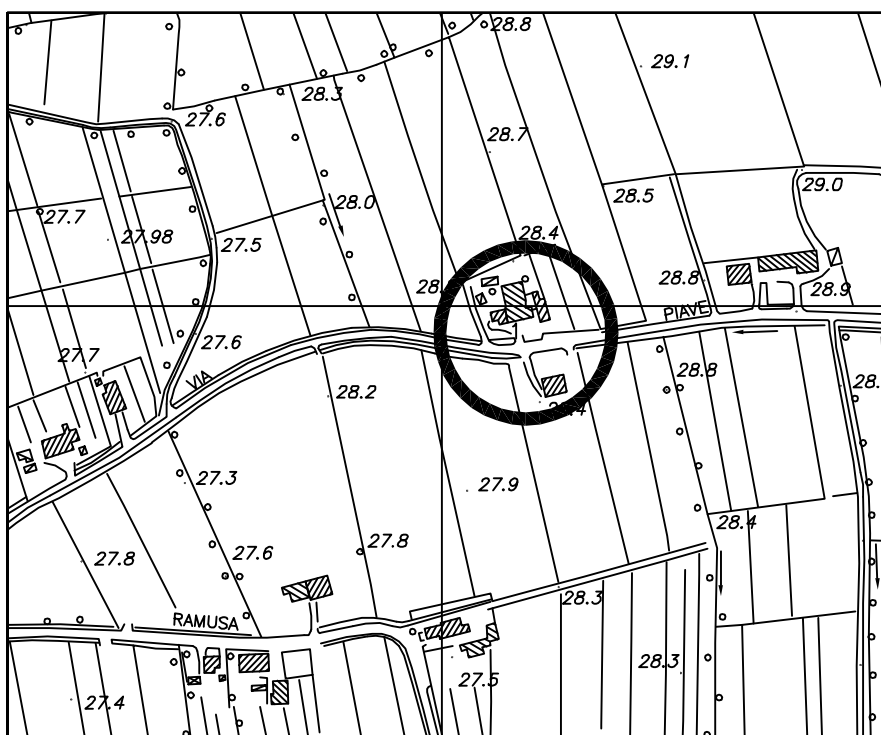

CARTOGRAFIA SCALA 1/5000

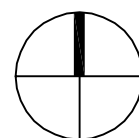

scala 1:5000

COMUNE DI S. GIORGIO IN BOSCO			
SCHEDA N°.	INDIRIZZO	folio catastale	mappale
OSS.32	VIA PIAVE, 3	30	90

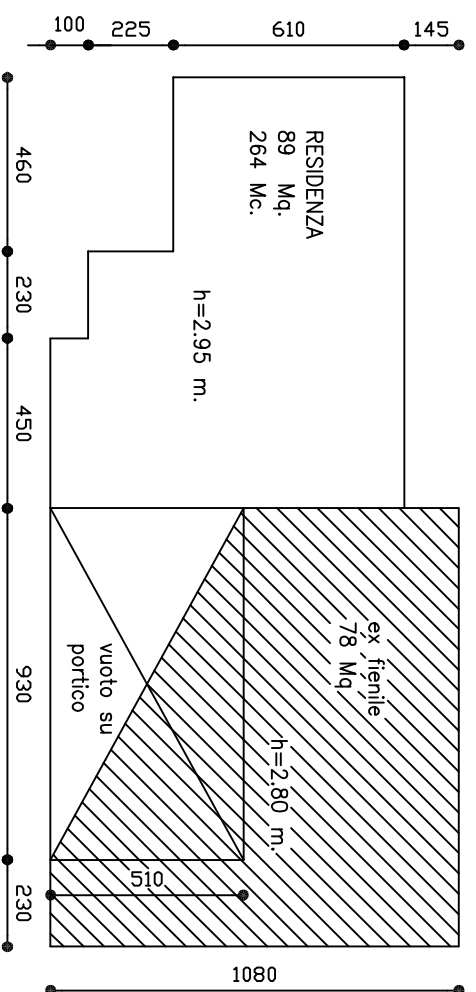
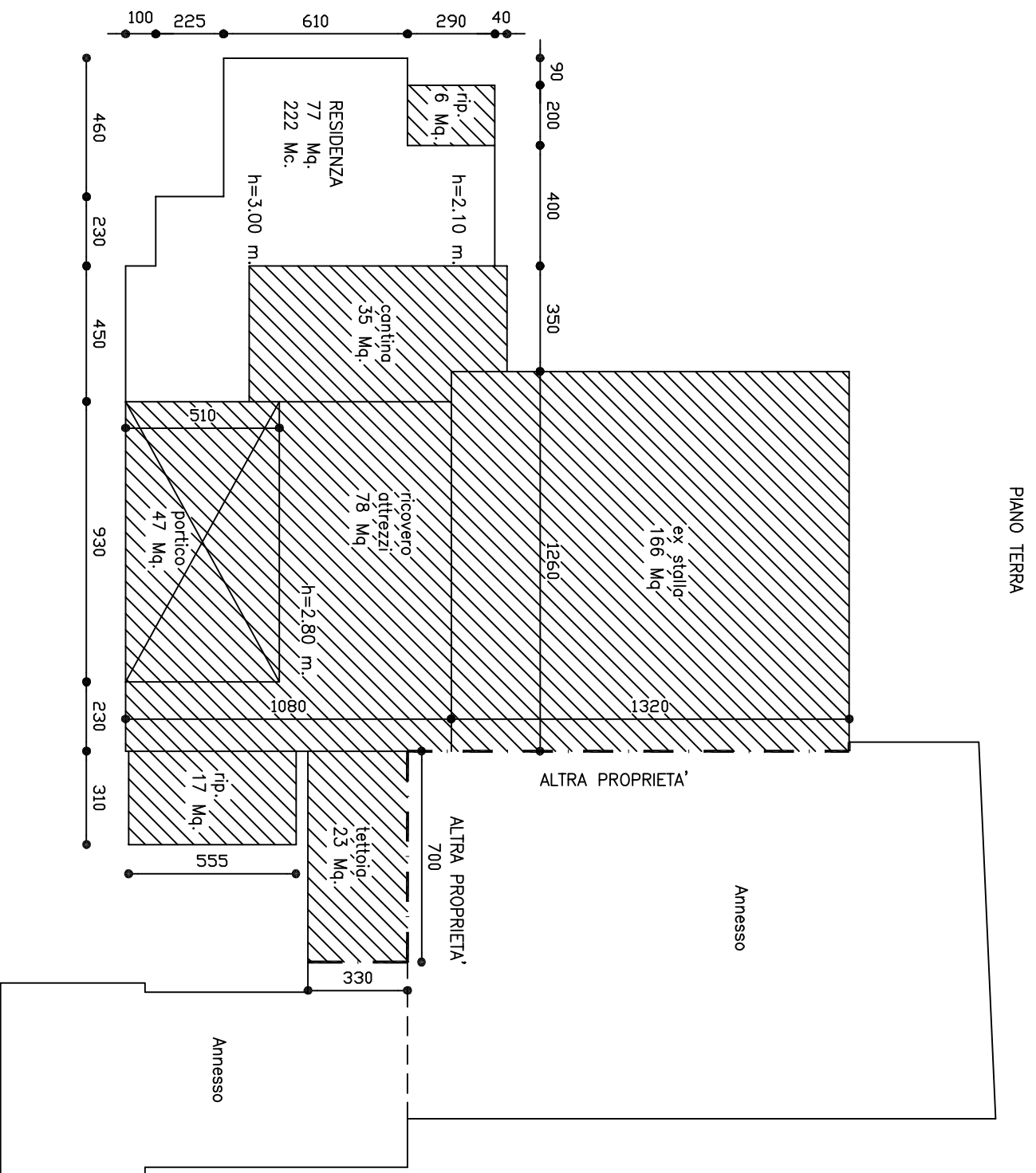

STATO DI FATTO

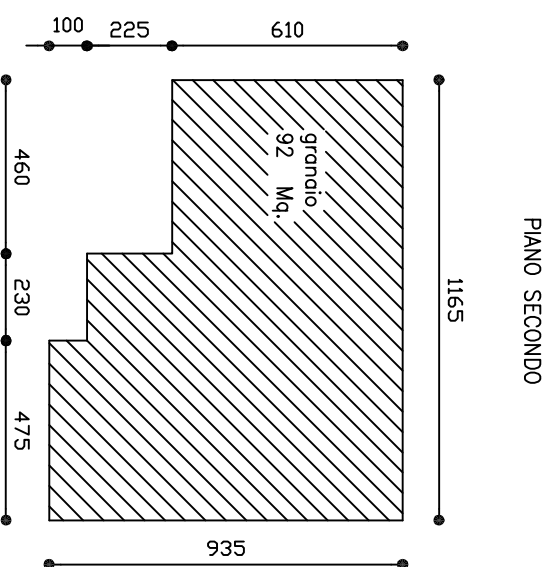

LEGENDA

Residenza

Fabbricati rurali

PAG.4

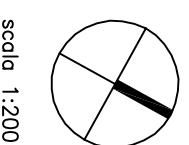

scala 1:200

COMUNE DI S. GIORGIO IN BOSCO			
SCHEDA N°.	INDIRIZZO	folio catastale	mappale
OSS.32	VIA PIAVE, 3	30	90

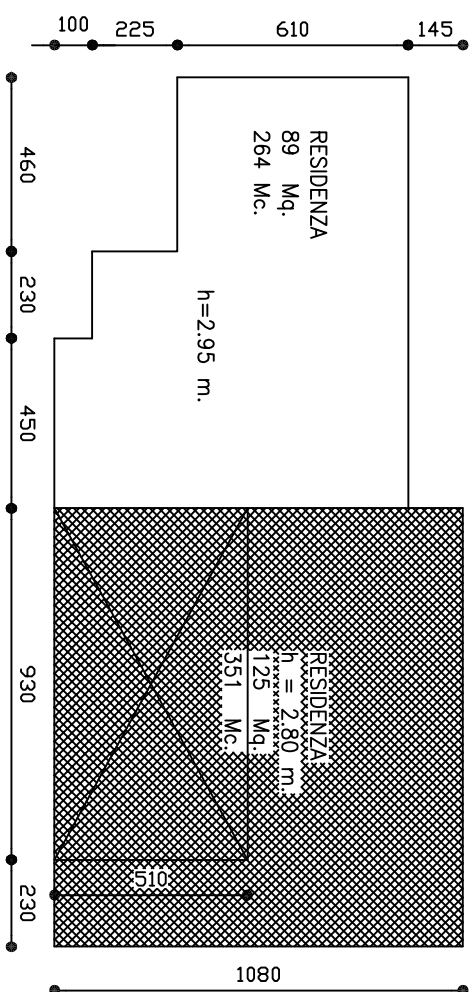
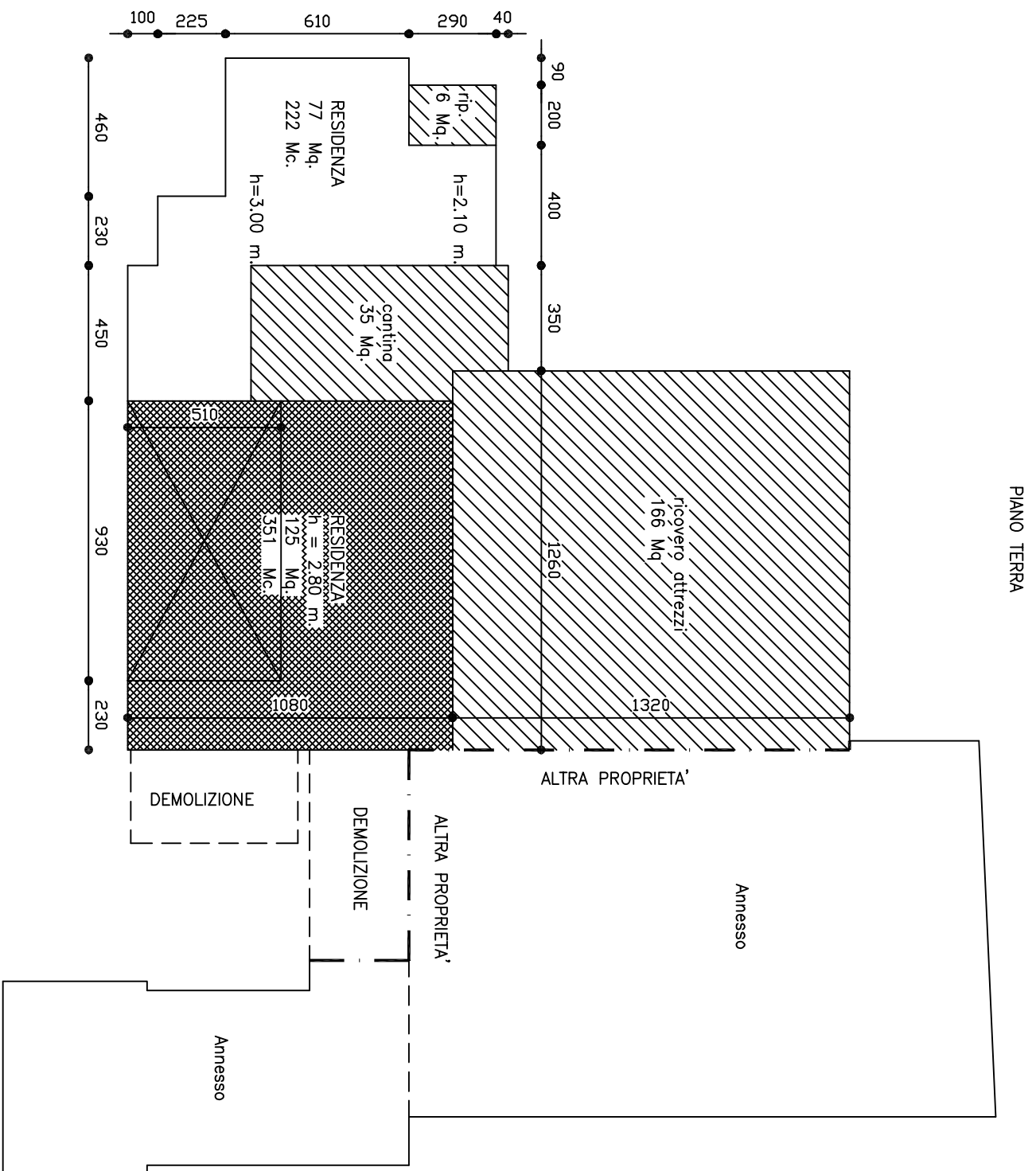

PROGETTO

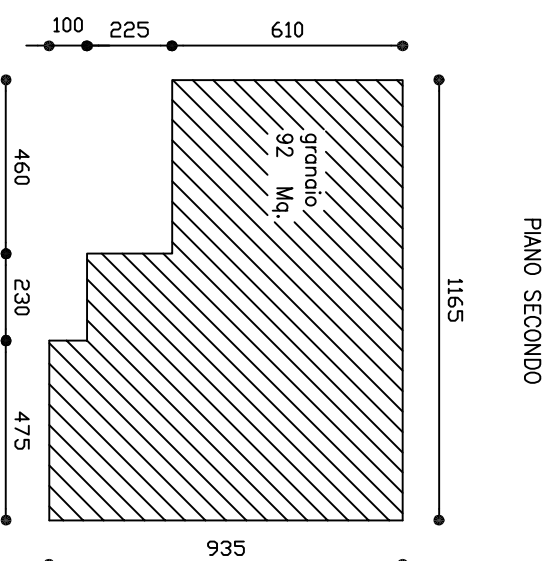

- LEGENDA
- Residenza
 - Fabbricati rurali
 - Parte interessata al cambio di destinazione

PAG.5

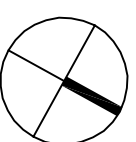

scala 1:200