

COMUNE DI S. GIORGIO IN BOSCO

PROVINCIA DI PADOVA

VARIANTE P.R.G. n°14

INDIVIDUAZIONE DEGLI ANNESSI RUSTICI NON PIU'
FUNZIONALI ALLE ESIGENZE DEL FONDO AGRICOLO
(ART. 4 L.R. n°24/85)

SCHEDA N°.	INDIRIZZO	foglio catastale	mappale
7-8-9	VIA COGNO	17	68-69



CARTOGRAFIA SCALA 1/2000

LEGENDA INTERVENTO UNITARIO SCHEDE N°7-8-9

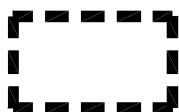

AMBITO U.M.I.



EDIFICI INTERESSATI DALL'INTERVENTO

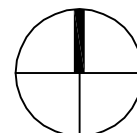

scala 1:2000

COMUNE DI S. GIORGIO IN BOSCO		
SCHEDA N°.	INDIRIZZO	foglio catastale
7-8-9	VIA COGNIO	17
		mappale
		67-68-69

NOTE: VEDI ANCHE INDICAZIONI SINGOLE SCHEDE N°7-8-9

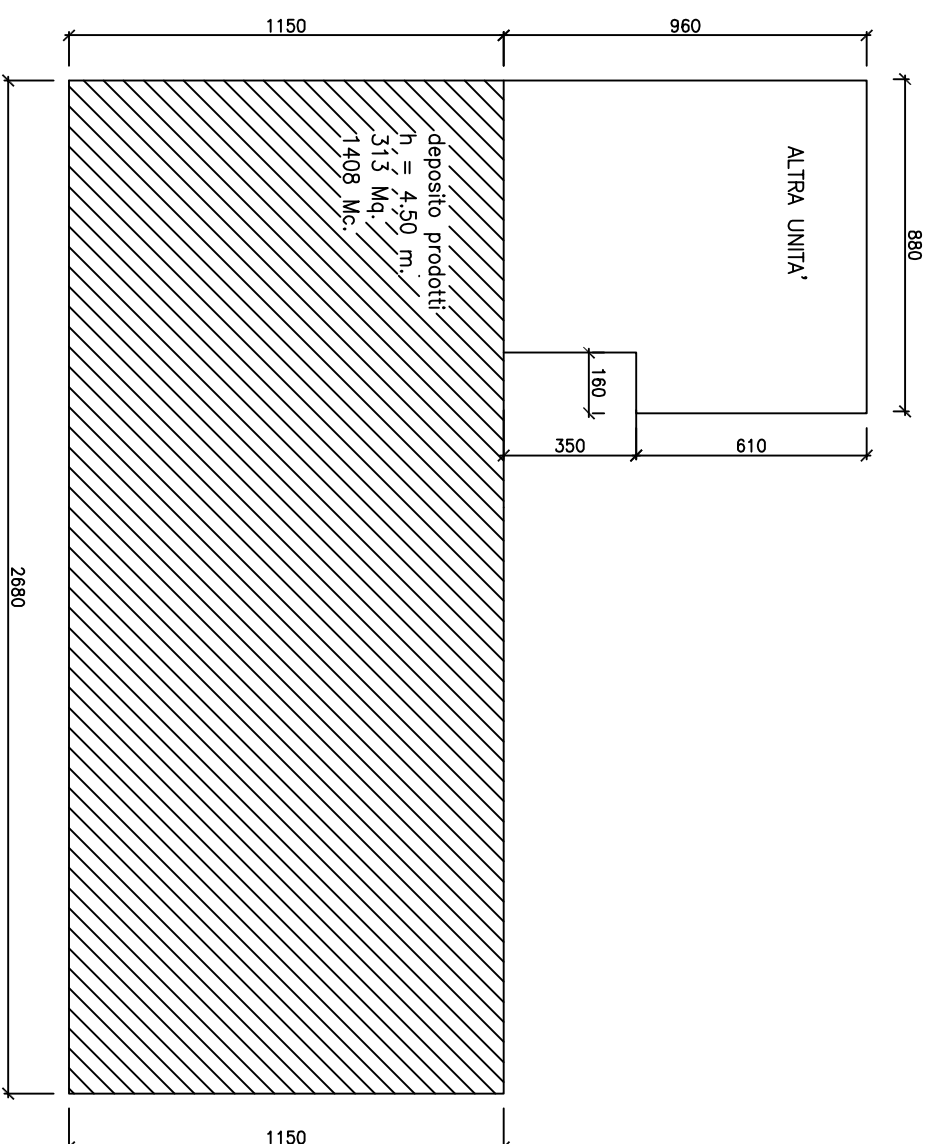
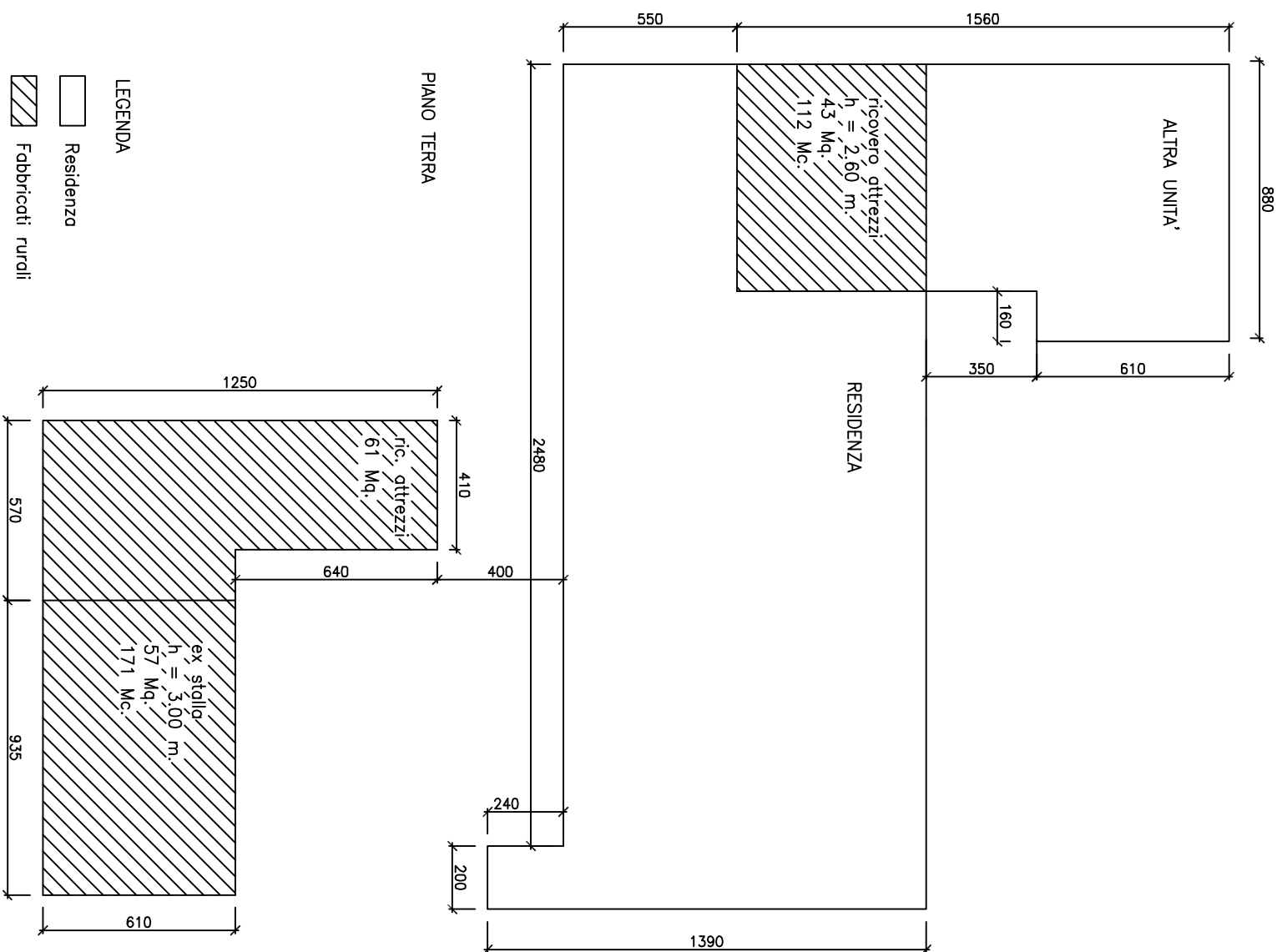

STATO DI FATTO

- LEGENDA
- Residenza
 - Fabbricati rurali

PAG.2

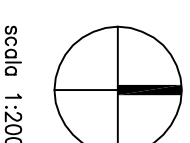
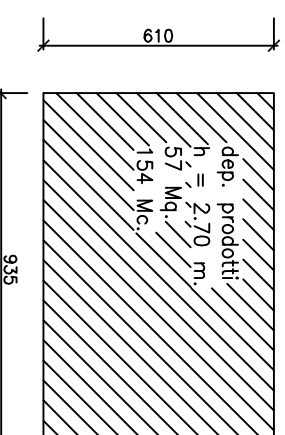

scala 1:200

COMUNE DI S. GIORGIO IN BOSCO		
SCHEDA N°.	INDIRIZZO	foglio catastale
7-8-9	VIA COGNO	17
		mappale
		67-68-69

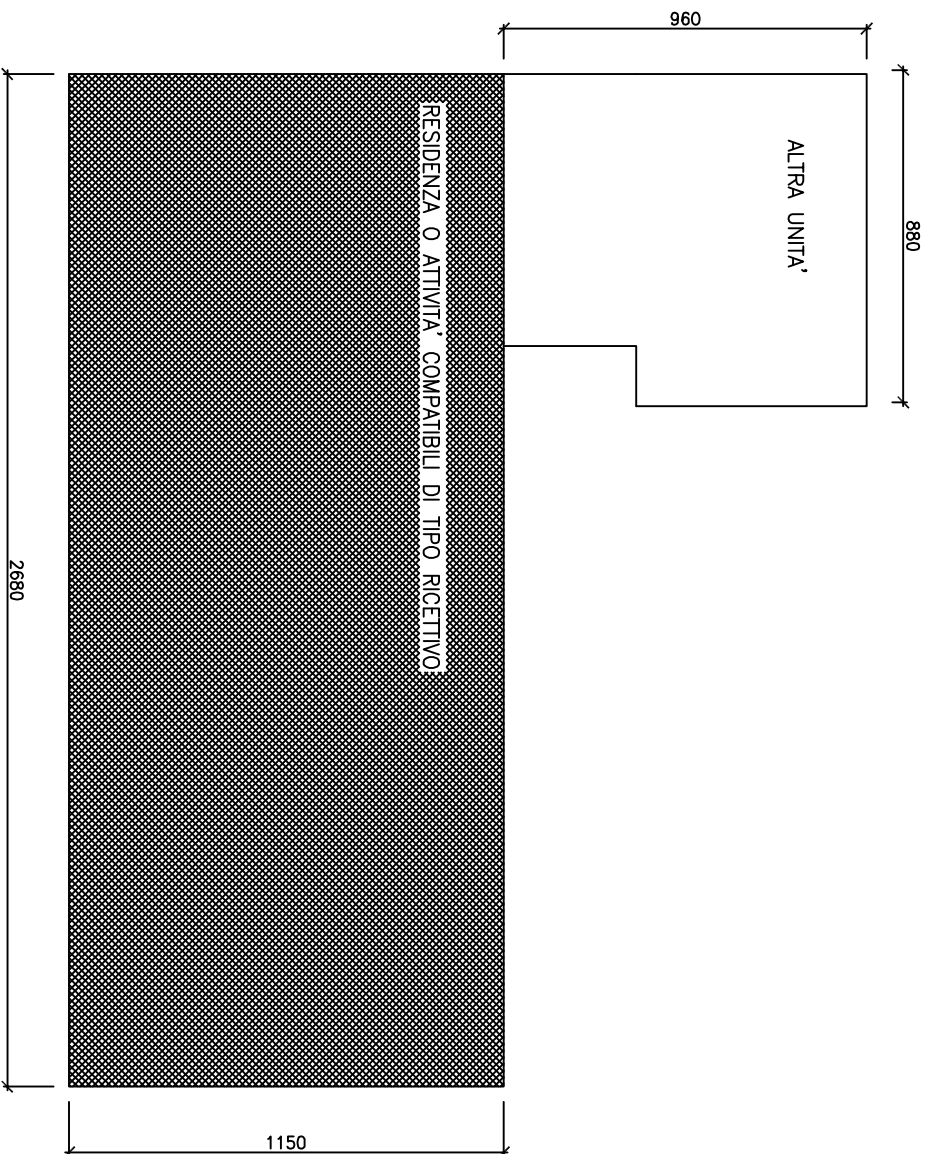

NOTE: VEDI ANCHE INDICAZIONI SINGOLE SCHEDE N°7-8-9

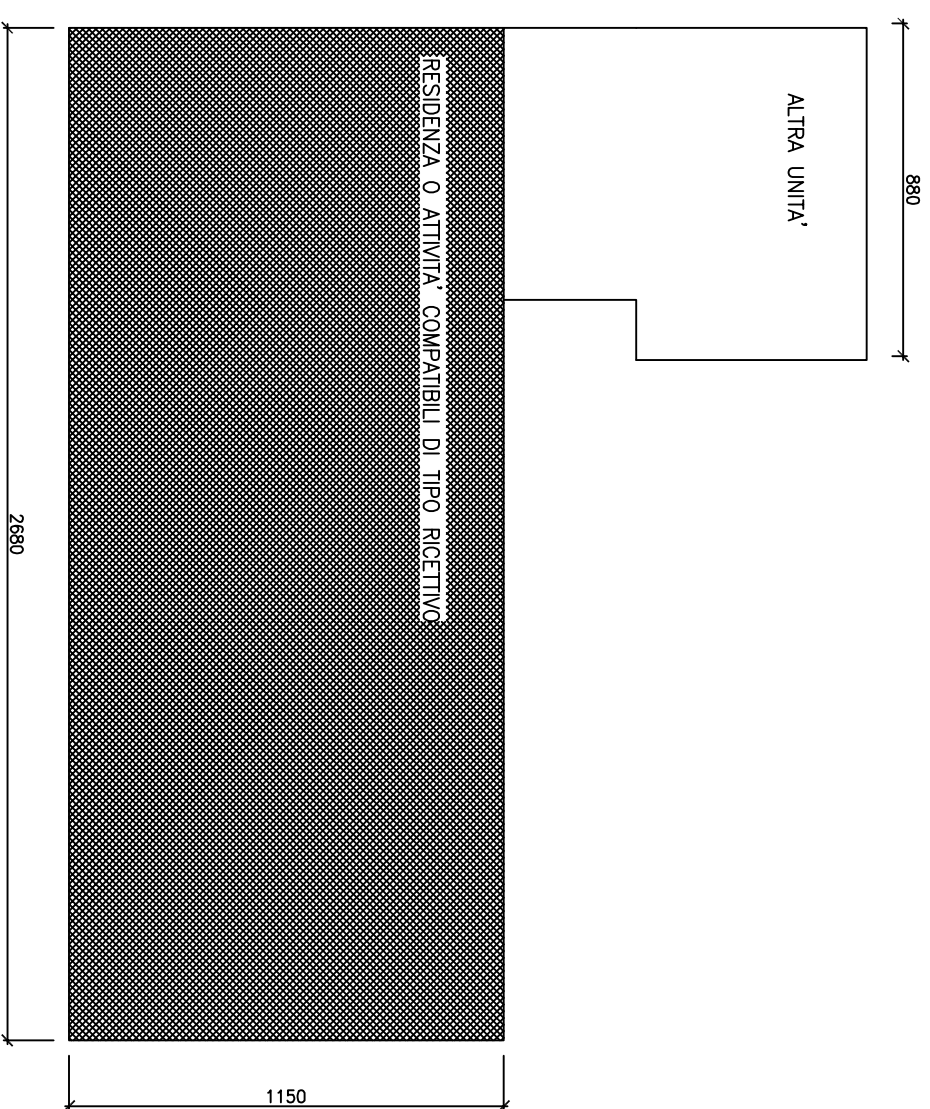

PIANO TERRA



PIANO PRIMO

- LEGENDA
-  Residenza
 -  Fabbricati rurali
 -  Parte interessata al cambio di destinazione

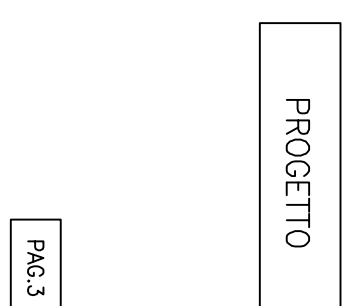
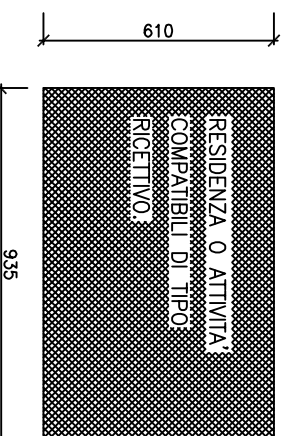

PAG.3

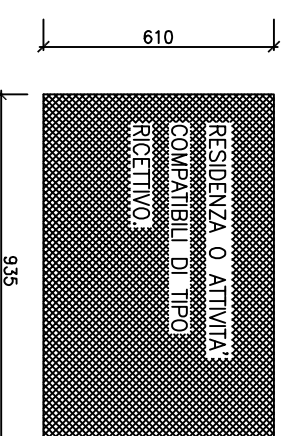

scala 1:200

